



FROM HERE  
*To*  
 MATERNITY

## SUPPORTING YOUR PREGNANCY WITH PROGESTERONE JUST GOT EASIER

INTRODUCING

# Endometrin<sup>®</sup>

(progesterone) Vaginal Insert 100mg

### WHAT IS ENDOMETRIN<sup>®</sup>?

ENDOMETRIN<sup>®</sup> is a vaginal insert that contains 100 mg of the hormone progesterone. Progesterone is one of the hormones essential in helping you to become and to stay pregnant.

The progesterone in ENDOMETRIN<sup>®</sup> will help prepare the uterine lining so that it is ready to receive and nourish a fertilized egg. Your doctor will prescribe ENDOMETRIN<sup>®</sup> starting at egg retrieval, and upon a positive pregnancy test, have you continue ENDOMETRIN<sup>®</sup> for up to 10 weeks total duration.

As with all medicines, please keep ENDOMETRIN<sup>®</sup> out of the reach of children.

### HOW ENDOMETRIN<sup>®</sup> WORKS:

The ENDOMETRIN<sup>®</sup> insert is progesterone that has been specially formulated to be administered via the vagina. The insert quickly dissolves and progesterone is absorbed through the vaginal tissue. ENDOMETRIN<sup>®</sup> contains no irritating perfumes or dyes.

### HOW TO USE ENDOMETRIN<sup>®</sup>:

Use ENDOMETRIN<sup>®</sup> exactly as prescribed. The dose is one insert placed in the vagina 2 to 3 times a day for up to a total of 10 weeks. Place an ENDOMETRIN<sup>®</sup> insert in your vagina with the disposable applicator provided. Do not use other vaginal products when using ENDOMETRIN<sup>®</sup>.

Please read the Patient Information enclosed with ENDOMETRIN<sup>®</sup>. However, this information does not replace discussions with your doctor or nurse.



### SIMPLE AND EASY TO USE

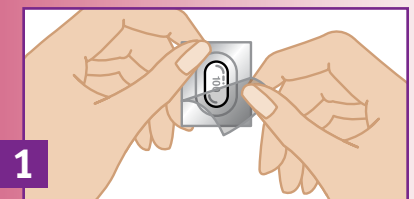

1

Unwrap the applicator and the ENDOMETRIN<sup>®</sup> insert.

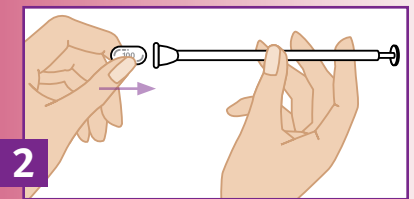

2

Put one ENDOMETRIN<sup>®</sup> insert into the space provided at the end of the applicator. The insert should fit snugly and not fall out.

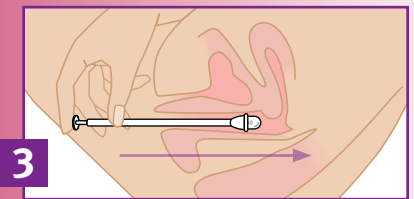

3

When using ENDOMETRIN<sup>®</sup>, you may be standing, sitting, or lying on your back with your knees bent. Gently slide the thin end of the applicator 2 to 3 inches into the vagina.

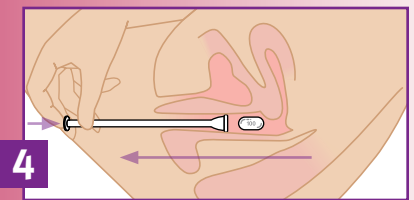

4

Push the bottom of the applicator upward to release the ENDOMETRIN<sup>®</sup> insert. Remove the applicator and throw it away in a waste container.

**NOTE:** If you miss a dose of ENDOMETRIN<sup>®</sup>, use it as soon as you remember, but do not use more than the recommended daily dose prescribed by your physician.

INTRODUCING

**Endometrin**<sup>®</sup>  
(progesterone) Vaginal Insert 100mg

**JOINING THE FERRING FAMILY OF FERTILITY MEDICATIONS**

**Menopur**<sup>®</sup>  
(menotropins for injection, USP)

**Bravelle**<sup>®</sup>  
(urofollitropin for injection, purified)

Provided as an educational service by

**FERRING**  
PHARMACEUTICALS

*Helping you achieve what your heart dreams.*

ENDOMETRIN<sup>®</sup> administered as a progesterone vaginal insert is indicated to support embryo implantation and early pregnancy by supplementation of the corpus luteal function as part of an Assisted Reproductive Technology (ART) treatment for infertile women.

Only physicians thoroughly familiar with infertility treatment should prescribe ENDOMETRIN<sup>®</sup>. In clinical trials (n=860), adverse reactions that occurred at a rate greater than or equal to 2% included: uterine spasm (3% to 4%) and vaginal bleeding (3%). Vaginal irritation, itching, burning or discomfort, urticaria, and peripheral edema were reported at an incidence of less than 2%. ENDOMETRIN<sup>®</sup> is expected to have adverse reactions similar to other drugs containing progesterone (breast tenderness, bloating, mood swings, irritability, and drowsiness).

MENOPUR<sup>®</sup> administered subcutaneously is indicated for the development of multiple follicles and pregnancy in the ovulatory patients participating in an ART program. BRAVELLE<sup>®</sup> administered SC in conjunction with hCG is indicated for multiple follicular development (controlled ovarian stimulation) during ART cycles in patients who have previously received pituitary suppression. BRAVELLE<sup>®</sup> administered SC or IM, in conjunction with hCG, is indicated for ovulation induction in patients who have previously received pituitary suppression.

Only physicians thoroughly familiar with infertility treatment, including the risk of multiple births and adverse reactions, should prescribe BRAVELLE<sup>®</sup> and MENOPUR<sup>®</sup>. BRAVELLE<sup>®</sup> and MENOPUR<sup>®</sup>, like all gonadotropins, are potent substances capable of causing mild to severe reactions, including OHSS (overall incidence of 6.0% for BRAVELLE<sup>®</sup> and 3.8% for MENOPUR<sup>®</sup>), with or without pulmonary or vascular complications, in women undergoing therapy for infertility.

*Please see accompanying full Prescribing Information for MENOPUR<sup>®</sup>, BRAVELLE<sup>®</sup>, and ENDOMETRIN<sup>®</sup>.*